



## **Attention: “2011 Society of Mineral Analysts Annual Conference and Exposition” - Potential Exhibitors**

The 2011 SMA Annual Conference and Exhibition registration is now open! Come and join us September 20th – 22nd in Elko, Nevada at the Elko Convention Center. The SMA annual conference and exhibition is devoted to the mining and industrial minerals analytical laboratories. It is a must-attend event that will connect your business with the people who make buying decisions on lab instrumentation, equipment, furnishings and services.

Don't miss out on this opportunity for face-to-face contact with the mining's leading chemical scientists and laboratory managers! Many of our valued exhibitors view the SMA as the single most important event for generating sales leads in this industry.

For the complete details concerning: Event Schedule, Technical Sessions, Exhibitor Services, Corporate Services, the Venue, Registration, etc. please visit our website at:

<http://www.sma-online.org/joomla15/>

*We look forward to your attendance at this year's event.*

---

### **Booth Details:**

- ✓ Booths are available on a first come first serve basis.
- ✓ Booth Location pre-registration can be made by contacting Patrick Braun
  - [services@sma-online.org](mailto:services@sma-online.org) or 208-553-8949
- ✓ For Booth location availability check our website
- ✓ All Booths are 8' x 10'
- ✓ Booth Cost is \$250 and includes one registration - additional people must register separately at \$75 each
- ✓ Each Booth Includes:
  - 1 Skirted Table
  - 2 Chairs
  - Pipe & Drape
  - Booth Identification Sign
  - 110 volt Electricity

## Booth Map:

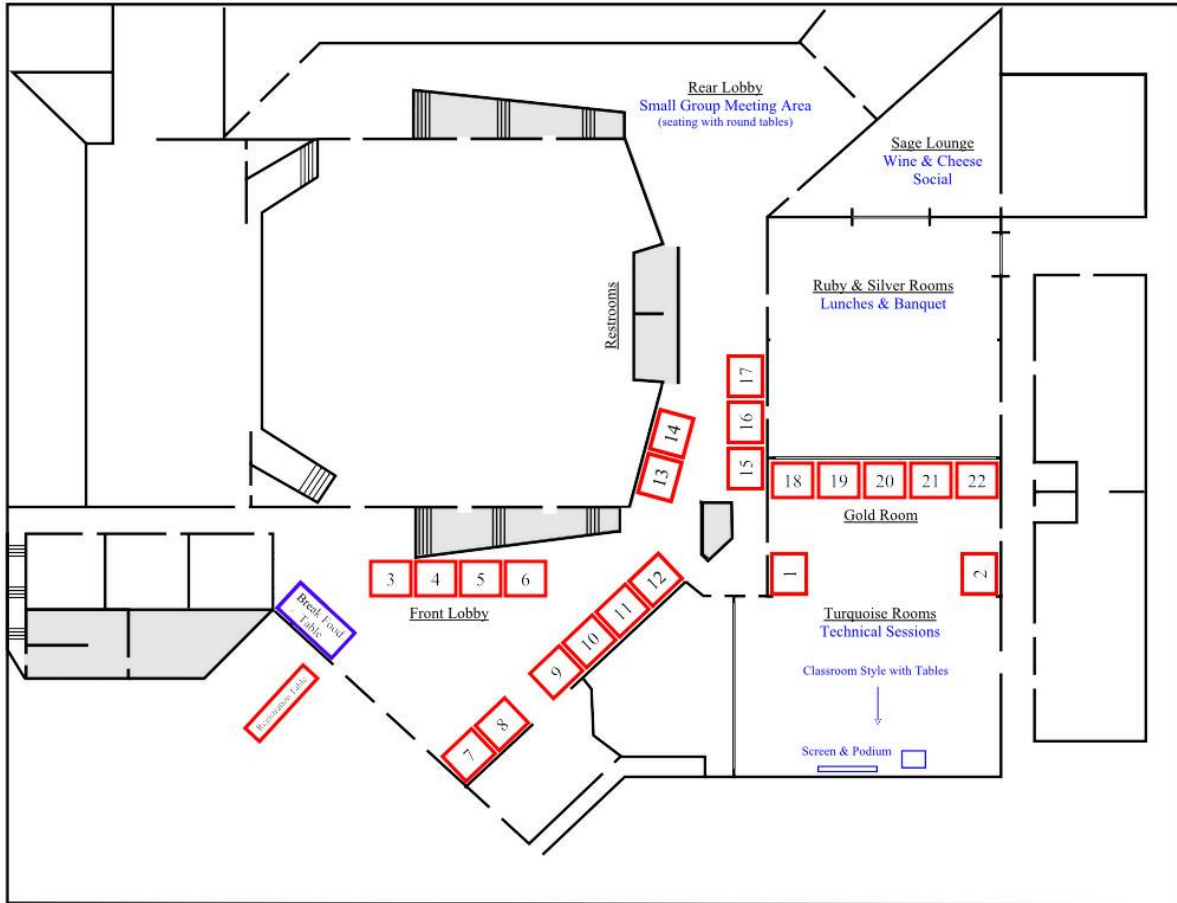

## Event Details:

- ✓ All registrations are to be handled online (preferred) or mailed directly to the SMA. Do not send registrations to SMA Vendor Representative: Peter Cavender.
- ✓ Exhibitor setup is on Tuesday September 20th from 8:00am to 5:00pm - **Exhibitors setting up late may lose their preferred booth location.** The “Wine & Cheese” will be in the vendor area so please have your booths setup before that evening.
- ✓ Exhibitor tear-down can occur between 4:00pm and 7:00pm on Thursday September 22nd and 8:00am to 12:00pm Friday September 23rd.
- ✓ Any promotional items that you would like to have included in registration packets must be given to Patrick Braun the afternoon of September 20th.
- ✓ The conference kicks off with the Golf Tournament in the afternoon on Tuesday the 20th. The cost is \$35.00 US. The “Wine & Cheese Social” starts at 7:00pm
- ✓ The Technical Sessions start 8:00am on Wednesday the 21st and last for two full days.

- ✓ The “Banquet” this year will be on the 22<sup>nd</sup>.
- ✓ There are a number of hotels in close proximity to the convention center so we have not made arrangements for special rates at any given hotel.

## **Event Contacts:**

- ✓ If you have non-registration related questions please contact the SMA's Vendor representative:
    - Peter Cavender
    - Anachemia Science
    - (775) 331-2300
    - [pcavender@anachemia.com](mailto:pcavender@anachemia.com)
  - ✓ If you have registration related questions please contact the SMA's Managing Secretary:
    - Patrick Braun
    - ATK – Security & Sporting Products
    - (208) 799-3286
    - [services@sma-online.org](mailto:services@sma-online.org)
  - ✓ Freight can be sent directly to the hotel prior to the conference, please contact:
    - Elko Convention Center
    - Sally Meyer, Catering Coordinator
    - 700 Moren Way
    - Elko, NV 89801
    - [sally@elkocva.com](mailto:sally@elkocva.com)
    - (775) 738-4091
- 

## **Additionally there are the following opportunities available for exhibitors to participate:**

- ✓ Event Sponsorships
  - Golf Tournament Awards
  - Wine & Cheese Social
  - Morning Breaks
  - Afternoon Breaks
  - Lunch
  - Banquet Entertainment
  - Banquet Social Hour
  - Morning Coffee & Donuts
  - Round Robin Award
  - Best Exhibit Award
  - Best Paper Award
  - Technician of the Year
  - Registration Gift
- ✓ Technical Presentations
  - Present a 15, 30, or 45 minute oral presentation on: new instrumentation, method development, product application, etc.

**Tentative Schedule of Events:**

	Sept - 20	Sept - 21	Sept - 22	Sept - 23
8am	Vendor Set-up	Technical Sessions	Technical Sessions	Additional Vendor Tear-Down Time
9am				
10am				
11am	Golf Tournament		Vendor Tear-Down	
12pm				
1pm	Wine & Cheese	Banquet		
2pm				
3pm				
4pm				
5pm				
6pm				
7pm				
8pm				
9pm				
10pm				